

PILE DRIVER

THE OFFICIAL PUBLICATION OF THE PILE DRIVING CONTRACTORS ASSOCIATION  | Q3 2011 VOL. 8, No. 3

Traylor-Massman-Weeks, LLC Inner Harbor Navigational Canal Floodwall

Project Spotlight:

- ▼ Dock Structure and Crane State Project – Caddo-Bossier Port Commission

PDCA Project of the Year:

Land, Greater Than \$2 Million

- ▼ NASA Taurus-II Rocket Launch Complex – Wallups Island, VA





PILE DRIVING CONTRACTORS ASSOCIATION
1857 Wells Road, Suite 215
Orange Park, FL 32073

1857 Wells Road, Suite 215
Orange Park, FL 32073
P.O. Box 66208
Orange Park, Florida 32065
Phone: 904-215-4771
Toll-free phone: 888-311-PDCA (7322)
Fax: 904-215-2977
www.piledrivers.org
e-mail: info@piledrivers.org

Published by:

Lester Publications, LLC
140 Broadway, 46th Floor
New York, NY 10005
Toll-free phone: 866-953-2189
Toll-free fax: 877-565-8557
www.lesterpublications.com

President

Jeff Lester

Vice President and Publisher

Sean Davis

Managing Editor

Stone Wallace

Graphic Design and Layout

John Lyttle, Myles O'Reilly

Advertising Executives

Quinn Bogusky, Kathy Kelley, Louise Peterson

© 2011 Pile Driving Contractors Association. All rights reserved. The contents of this publication may not be reproduced by any means, in whole or in part, without the prior written consent of the PDCA.

PileDriver magazine is published quarterly.

Visit the PDCA Web site at www.piledrivers.org for more information or to download an advertising media kit.

Individual articles can be provided upon request to the PDCA office. Requests should be submitted to the PDCA via e-mail at info@piledrivers.org or by calling 888-311-PDCA (7322).

Please contact us by mail at P.O. Box 66208, Orange Park, FL 32065
Phone: 904-215-4771 | Fax: 904-215-2977
or by e-mail at info@piledrivers.org

Statements of fact and opinion are the responsibility of the authors alone and do not imply an opinion on the part of the officers or members of the Pile Driving Contractors Association. Materials may not be reproduced or translated without written permission. Direct requests for reprint permission should be made to the executive director of the Pile Driving Contractors Association.

Unless otherwise credited, stock photography is from www.photos.com.

Printed in Canada.
Please recycle where facilities exist.



PILEDRIVER

THE OFFICIAL PUBLICATION OF THE PILE DRIVING CONTRACTORS ASSOCIATION | Q3 2011 VOL. 8, NO.3

Contents

PILEDRIVER

President's Message	5
Executive Director's Message	9
2011 Board of Directors and Committee Chairmen	12
PDCA Membership Benefits	17
PDCA Membership Application	19
Did You Know?	21
2011 PDCA New Members	25
DICEP Announcement	27
6 th Professors' Driven Pile Institute Completed	29

Project Spotlight:

NASA Taurus-II Rocket Launch Complex Wallups Island, VA	49
Dock Structure and Crane State Project for Owner Caddo-Bossier Port Commission	55

International:

Umm Qasr Pier and Seawall	33
-------------------------------------	----

Legal:

The False Claims Act: What Every Contractor Needs to Know	37
--	----

Featured Articles:

Lundeen Parkway Soldier Pile Wall	41
Inner Harbor Navigational Canal Floodwall	59
Construction of New Breasting Dolphins for National Gypsum Company's (NGC) Richmond, California Terminal	67
Getting Employees to Apply Training on the Job	71
Salt Damage to Wood	85

PDCA Associate Member Profiles:

Fugro Consultants, Inc.	75
Juttan Oy.	79

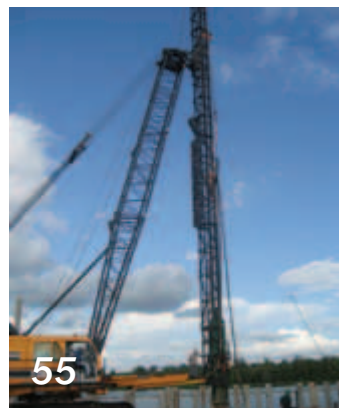

On the Cover:
Traylor-Massman-Weeks installs marine piling for the Inner Harbor Navigational Canal Floodwall.
Find out more about Traylor-Massman-Weeks on page 59.

Lundeen Parkway Soldier Pile Wall

SR9 Lundeen Parkway to SR 92 Intersection Improvements and Widening

History

The Washington State Department of Transportation (WSDOT) is the steward of over 18,000 miles of state highway lanes and 3,600 bridges, with 7,200 full-time employees. WSDOT, working closely with private contractors, is in year five of a twenty-year program that will be the largest capital construction program in their history - delivering more than \$15 billion in projects, including 391 highway projects valued at \$11 billion.

Problem

A fast-growing area in the Eastern suburbs of Seattle, Snohomish County's population grew by 80 percent between 1980 and 2000 – and as the population has grown, traffic congestion has increased as well.

State Route 9 (SR 9) is the only North-South highway on the East side of Snohomish County and the only major alternative to nearby Interstate 5. This once-rural two-lane road has seen a significant increase in traffic volumes, leading to a rise in collisions, particularly at intersections where drivers have to cross oncoming traffic when making left turns.

From 1993 to 2000, Snohomish County saw an average of 325 collisions per year on the SR 9 corridor. By 2007, that average had increased to almost 450 collisions per year (an increase of 38%). The WSDOT is working to improve safety and reduce congestion by widening SR 9 to four lanes and adding turning lanes at intersections.

Road widening of the Lundeen Parkway required filling of the lower side of the highway.

This process resulted in the construction of soldier pile walls to support the newly placed back fill material. Skyline

Steel was contacted by Malcolm Drilling Company, Inc. to provide wide flange sections for new soldier pile walls. Originally, the project called for wide flange (W14 x 159) sections which were only available at a premium price and are rolled at set times due to tight mill rolling schedules. Temporary casing limitations also made the wide flange product more difficult to install, so Malcolm Drilling was open to alternatives in this application.

Solution

Skyline Steel provided Malcolm Drilling with a cost analysis and suggested using H-piles (HP16 x 162) as a less expensive alternative. This represents cost savings for the project owner, WSDOT. This size of H-pile is stiffer and also has a larger bending moment capacity than the W14 x 159. Due to the uniform geometry of this product, H-piles also allowed for a simplified drilling process. Once design properties and drawings of the proposed sections were approved, Skyline Steel provided customized H-pile beams containing pockets to allow the tie rods to pass through (See Figure 1).

In keeping with the company's goal of serving as a True Project Partner, the Skyline Steel team was actively involved in every

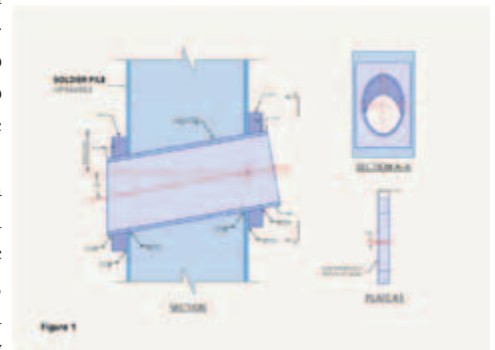

FEATURED ARTICLES



phase of the project including manufacturing, fabrication, coating, and coordinating the logistics for final delivery to the job site. Drawing upon its strengths, Skyline Steel was able to quickly deliver a solution that would normally have required the involvement of multiple vendors. For the client, Skyline Steel's industry expertise and reliability helped deliver significant cost savings, and knocked three weeks off the project's timeline.

Project Time Frame

Wall B or Phase 1: Summer 2010
Wall A or Phase 2: December 2011

Project Partners

Owner/Engineer
Washington State DOT
Mount Vernon, Washington
Ph: 360-428-1593

General Contractor
Granite Construction Company
1525 E. Marine View Drive
Everett, Washington
Ph: 425-551-3100

Sub-contractor
Malcolm Drilling Company, Inc.
Kent, Washington
Ph: 253-395-3300

Products

Product
H-piles: HP16 x 162

Steel Grades
ASTM A572 Gr. 50

Quantity
Wall A: 316 tons
Wall B: 323 tons
Total: 639 tons

Photos courtesy of Skyline Steel, LLC
www.skylinesteel.com

For technical questions and engineering support, please contact us via our technical hotline at: 1-866-875-9546 or email us at: engineering@skylinesteel.com.



SEABOARD STEEL CORP.

Sales & Rentals

- Steel Sheet Pile & Bracing Systems
- Steel HP Bearing Piles
- Vibratory Driving Hammers
- Diesel and Hydraulic Impact Hammers

Seaboard Steel Corporation
P.O. Drawer 3408
Sarasota, FL 34230-3408

1800-533-2736 • SeaboardSteel.com



The Piling Cutter Tool

eliminates shimming

all cuts created equal

- Good for round and square piles/posts
- All cuts perfectly level and accurate
- Attaches to any chainsaw
- 6", 8", 12", and custom sizes available



Ferreras Equipment LLC

PHONE (907) 852-7310

www.pile-cutter.com



SHORELINE STEEL, INC

DOMESTIC STEEL SHEET PILING

THOMAS M. WILLEY

Phone: (800) 522-9550

(586) 749-9559

Res: (248) 545-1745

58201 Main St.

Fax: (586) 749-6653

New Haven, MI 48048

Email: tomwilley@shorelinesteel.com

<http://www.shorelinesteel.com>